

VYR-36



VYR-36 · Agrícolas circulares

GENERAL PROPERTIES:

- Medium flow agricultural impact sprinkler.
- 3/4" male or female connection.
- Made of plastic and stainless steel.
- High-resistance rotating joints.
- Nozzle angles of 25° and 25°
- Used in full coverage irrigation with the best compliance with spacing standards in the market.
- Curved design of the internal angles of the body to avoid internal hydraulic turbulence and for greater reach.
- Nickel plating steel ball counterweights inserted in the arm.
- Plastic sprinkler, leader in the agricultural market.

TECHNICAL SPECIFICATIONS:

- Range distance: 13 - 18 m / 43-60 ft.
- Flow: 660 - 3270 L/H / 175-864 GPH
- Working pressure: 1,75 - 4,5 BAR / 25-65 PSI.
- Area: Full circle.
- Nozzles: Two nozzles: one main nozzle and a secondary deflector nozzle or plug.
- Trajectory angles: 25° and 25°
- Maximum stream height: 4 m / 14 ft.
- Rotation time: Depending on the pressure and the nozzles, the rotation will be constant and continuous.
- Uniformity coefficient higher than 90% in areas of 18x18R, 15x18T and 18x18T (meters).

APPLICATIONS:

- This model is compatible with almost any type of crop and with a wide range of pluviometric and spacing conditions, suitable for a large number of different crop types.
- Horticultural plantations, cereals, tubers, leguminous plants and fruit trees.

MEASUREMENTS:

- Height: 14 cm / 5,5 in.
- Width: 17 cm / 6,7 in.
- Weight: 178 g / 0,40 Lbs.
- Units per box: 100

OPTIONS:

- Threads in BSP or NPT under demand.
- Models with anti-frost cover with male or female connection.
- Brass or plastic nozzles, depending on the customer's technical specifications.
- Secondary nozzle with deflector slot or plug.
- Assembled on a pressure regulator for self-compensation of pressure and flow.

MODELS:

- Ref. 003600: 3/4" male.
- Ref. 003602: 3/4" female.
- Ref. 003620: 3/4" male, anti-frost.
- Ref. 003622: 3/4" female, anti-frost.





TABLES & PARTS

Technical guidance table VYR-36

NOZZLE	Spacing (m) / Precipit. rate (mm/h) Spacing (ft) / Precipit. rate (in/h)						
	BAR PSI	12x12 40x40	12x15 40x50	15x15 50x50	15x15 T 50x50 T	15x18 T 50x60 T	18x18 60x60
3,6 x 2,4 mm 9/64" x 3/32"	3	8,5	6,8	5,4	5	3,7	3,8
	44	0,33	0,27	0,21	0,20	0,15	0,15
	3,5	9,2	7,4	5,9	5,4	4	4,1
4 x 2,4 mm 5/32" x 3/32"	51	0,36	0,29	0,23	0,21	0,16	0,16
	4	9,8	7,9	6,3	5,8	4,3	4,4
	58	0,39	0,31	0,25	0,23	0,17	0,17
4,4 x 2,4 mm 11/64" x 3/32"	3	9,9	7,9	6,3	5,9	4,3	4,4
	44	0,39	0,31	0,25	0,23	0,17	0,17
	3,5	10,7	8,6	6,8	6,3	4,7	4,8
4,8 x 3,2 mm 3/16" x 1/8"	51	0,42	0,34	0,27	0,25	0,19	0,19
	4	11,4	9,1	7,1	6,8	5	5,1
	58	0,45	0,36	0,28	0,27	0,20	0,20
4,4 x 2,4 mm 11/64" x 3/32"	3	12,2	9,9	7,3	7	5,8	4,8
	44	0,48	0,39	0,29	0,28	0,23	0,19
	3,5	13,1	10,8	7,1	7,5	6	5
4,8 x 3,2 mm 3/16" x 1/8"	51	0,52	0,43	0,28	0,30	0,24	0,20
	4	14	11,9	8,3	8	7,2	5,4
	58	0,55	0,47	0,33	0,31	0,28	0,21
4,8 x 3,2 mm 3/16" x 1/8"	3	15,1	12,1	9,7	9	6,6	6,7
	44	0,59	0,48	0,38	0,35	0,26	0,26
	3,5	16,3	13,1	10,5	9,7	7,1	7,3
3/16" x 1/8"	51	0,64	0,52	0,41	0,38	0,28	0,29
	4	17,5	14	11,2	10,3	7,6	7,8
	58	0,69	0,55	0,44	0,41	0,30	0,31

T: Triang. CU < 85% CU 85-88% CU 88-92% CU > 92%

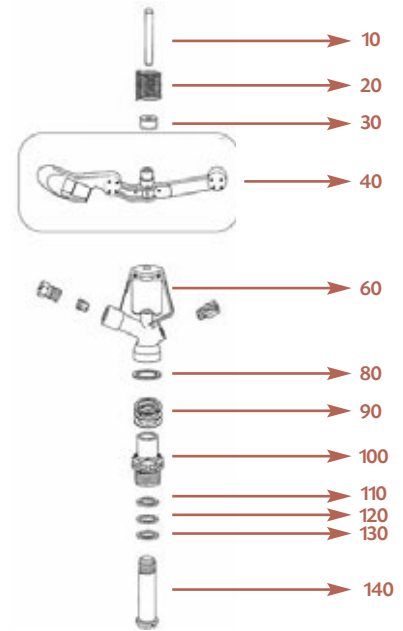

Performance nozzle table VYR-36

Long range nozzle (long vane) + plug

Standard Ø: Diameter range

NOZZLE	3,2 mm 17/128"		3,6 mm 9/64"		4 mm 5/32"		4,4 mm 11/64"		4,8 mm 3/16"		5,2 mm 13/64"		5,6 mm 7/32"	
	BAR PSI	L/H GPH	Ø m Ø ft	L/H GPH	Ø m Ø ft	L/H GPH	Ø m Ø ft	L/H GPH	Ø m Ø ft	L/H GPH	Ø m Ø ft	L/H GPH	Ø m Ø ft	L/H GPH
2	565	26	760	26,5	883	27,5	1069	28,5	1272	30	1493	31	1732	32
29	149	85	201	87	233	90	282	94	336	98	394	102	458	105
2,5	620	26	790	26,5	970	27,5	1160	29	1390	31	1640	31,5	1720	33
36	164	85	209	87	256	90	306	95	367	102	433	103	454	108
3	680	26	860	26,5	1050	28	1270	29,5	1510	32	1790	32,5	1880	34
44	180	85	227	87	277	92	335	97	399	105	473	107	497	112
3,5	740	26,5	930	27	1140	29,5	1380	31	1640	33	1930	33,5	2140	35
51	195	87	246	89	301	97	365	102	433	108	510	110	565	115
4	790	26,5	1000	28	1220	29,5	1470	32	1750	33,5	2060	34,5	2240	36
58	209	87	264	92	322	97	388	105	462	110	544	113	592	118
4,5	840	27	1060	29	1290	30	1550	32,5	1860	34	2180	35	2410	36,5
65	222	89	280	95	341	98	409	107	491	112	576	115	637	120
5	880	27,5	1120	29,5	1360	30,5	1640	33	1960	34,5	2290	35,5	2520	37,5
73	232	90	296	97	359	100	433	108	518	113	605	116	666	123
5,5	930	28	1170	30	1430	31	1720	34	2060	36	2380	36	2640	39
80	246	92	309	98	378	102	454	112	544	118	629	118	697	128

(Sprinkler at 1 meter height)

Long range nozzle (long vane) + short range nozzle

NOZZLE	2,8 x 2,4 mm 7/64 x 3/32"		3,2 x 2,4 mm 17/128 x 3/32"		3,6 x 2,4 mm 9/64 x 3/32"		4 x 2,4 mm 5/32 x 3/32"		4,4 x 2,4 mm 11/64 x 3/32"		4,4 x 2,8 mm 11/64 x 7/64"		4,8 x 2,4 mm 3/16 x 3/32"		4,8 x 2,8 mm 3/16 x 7/64"		4,8 x 3,2 mm 3/16 x 17/128"		5,2 x 3,2 mm 13/64 x 17/128"		5,6 x 3,2 mm 7/32 x 17/128"	
	BAR PSI	L/H GPH	Ø m Ø ft	L/H GPH	Ø m Ø ft	L/H GPH	Ø m Ø ft	L/H GPH	Ø m Ø ft	L/H GPH	Ø m Ø ft	L/H GPH	Ø m Ø ft	L/H GPH	Ø m Ø ft	L/H GPH	Ø m Ø ft	L/H GPH	Ø m Ø ft	L/H GPH	Ø m Ø ft	L/H GPH
2	700	23	883	26	1034	26,5	1201	27,5	1387	28,5	1502	28,5	1560	30	1705	30	1837	30	2058	31	2297	32
29	185	75	233	85	273	85	317	90	366	94	397	94	412	98	450	98	485	30	544	102	607	105
2,5	830	24	980	26	1150	26,5	1320	27,5	1520	29	1730	30,60	1750	31	1895	31	2050	31	2310	31,5	2460	33
36	219	79	259	85	304	87	349	90	402	95	457	100	462	102	501	102	542	102	610	103	650	108
3	900	24	1070	26	1250	26,5	1450	28	1670	29,5	1800	31,60	1920	32	2100	32	2240	32	2520	32,5	2730	34
44	238	79	283	85	330	87	383	92	441	97	476	104	507	105	555	105	592	105	666	107	721	112
3,5	965	24,5	1160	26,5	1350	27	1560	29,5	1800	31	1915	32	2050	33	2255	33	2420	33	2720	33,5	2915	35
51	255	80	316	87	350	89	412	97	476	102	506	105	542	108	596	108	639	108	719	110	770	115
4	1050	24,5	1240	26,5	1450	28	1670	29,5	1920	32	2070	32,4	2180	33,5	2400	33,5	2590	33,5	2910	34,5	3035	36
58	277	80	328	87	383	92	441	97	507	105	547	106	576	110	634	110	684	110	769	113	802	118
4,5	1100	25	1320	27	1540	29	1770	30	2030	32,5	2165	33	2300	34	2545	34	2750	34	3070	35	3170	36,5
65	291	82	349	89	407	95	468	98	536	107	572	108	608	112	672	112	726	112	811	115	837	120
5	1160	25,5	1360	27,5	1620	29,5	1870	30,5	2140	33	2300	33,4	2430	34,5	2680	34,5	2880	34,5	3230	35,5	3300	37,5
73	306	84	359	90	428	97	494	101	565	108	608	110	642	113	708	113	761	113	853	116	872	123
5,5	1200	26	1460	28	1700	30	1960	31	2240	34	2400	33,8	2510	36	2810	36	3010	36	3360	36	3430	39
80	317	85	386	92	449	98	518	102	592	112	634	111	663	118	742	118	795	118	888	118	906	128

(Sprinkler at 1 meter height)



- In shady areas is highly recommended the use of low pressure orange vane.
- Sprinklers will be supplied with standard nozzles unless otherwise specified.
- In order to calculate the flow, add the flows of the two nozzles. The range of the rear nozzle must be less than that of the main nozzle.
- These results has benn obtained at indoor laboratory with 0 m/seg win velocity. Outdoor results may change range distances.